

# BEPPU CITY TRADITIONAL BAMBOO CRAFTS CENTER

## 別府市竹細工 伝統産業会館



Address: 8-3, Higashisoen Beppu City, Oita Pref. 874-0836, JAPAN Phone : 0977-23-1072 E-mail : takezaiku@takezaikudensankaikan.jp



### Access

- [by Bus]** ● From JR Beppu Station West Exit:  
Take Kannawa Line (No. 2), APU Line (No. 5), Beppu Rehabilitation Line (No. 7), or Safari Line (No. 41), get off at “Hikari no Sono”, and walk for 10 mins.  
● From JR Beppu Station East Exit or Kitahama Bus Terminal:  
Take Kannawa Line (No. 25) and get off at “Bamboo Crafts Center”.

**[by Taxi]** ● From JR Beppu Station West Exit: About 10 mins.

- Phone 0977-23-1072
- Fax 0977-23-1085
- OPEN 8:30AM – 5:00PM
- CLOSED Monday (or Tuesday when Monday falls on a national holiday) and Dec.29 through Jan. 3
- Entrance Fee High school students and older: 390 yen (tax included)  
Junior-high school and elementary school students: 130 yen (tax included)
- Group Rate High school students and older/20 persons or more: 330 yen each  
Junior-high school and elementary school students /20 students or more: 91 yen each
- Reservation Reservation is necessary for groups and hands-on experience. Please contact us in advance.

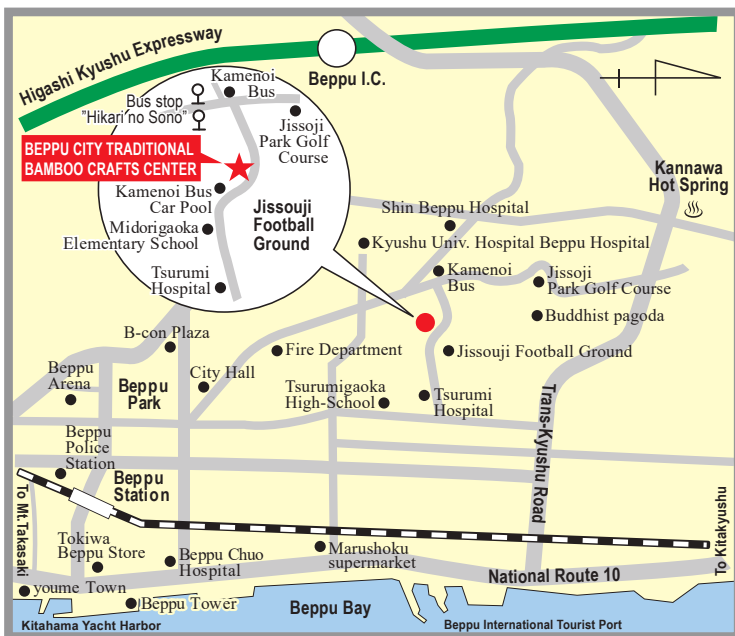

### Hands-on Experience

Nowadays, handmade products using natural materials have become more and more appreciated. This Center provides a hands-on experience so that visitors can become more interested in bamboo crafts in a short amount of time.



Shikainami (flower basket)

Fee for hands-on experience: 2,000 yen  
Required time: Approx. 60 min.  
Intended participants:  
Junior-high school students and older

Note: Please make a reservation for hands-on experience at least a week in advance. However, your reservation might be declined depending on the schedule of the Center.



Bamboo bell

Fee for hands-on experience: 500 yen  
Required time: Approx. 40 min.  
Intended participants:  
Middle years students of elementary school and older

### Bamboo Class



The Bamboo class is held twice a week to ensure that the techniques and tradition of bamboo craftsmanship will be properly handed down to next-generation Beppu bamboo artisans. Many trainees learn in this class and general visitors can also view the class while skilled instructors offer guidance for the trainees. The Center holds an exhibition to present their achievements every March and many people visit the Center then.



## Origin of Beppu Bamboo Ware

The origin of “Beppu Bamboo Ware” can be traced back to the time of the 12th Emperor Keikoh (13 B.C. – 130 A.D.) While he was visiting Beppu on his way back from his subjugation of Kyushu Kumaso, one of his subordinates (in charge of cooking) found that there were many quality bamboos suitable for creating baskets, containers and utensils. It is said that this was the beginning of Beppu Bamboo Ware.

At the beginning of Edo Period (1603-1868), Beppu had already gained a reputation as a good spa across Japan and visitors seeking hot-spring cures began to buy kitchen utensils, such as miso strainers, rice bowls or baskets for drying rice, as souvenirs.

Consequently, market places for bamboo ware began to flourish, firmly establishing themselves as a local industry in their own right.

An apprentice’s school (predecessor of the current Oita Prefecture Technical High School) was established in 1902 to nurture artisans for modern bamboo crafts, leading to the production base of the current masterful bamboo artworks.

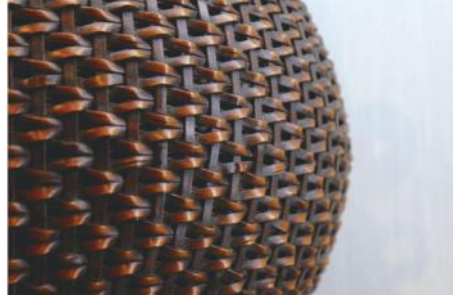
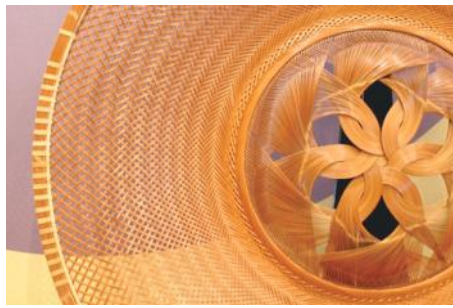

## Techniques to Be Handed Down

Using the superior quality of bamboo, madake, as their main material, for which Oita Prefecture boasts the largest output in Japan, Bamboo artisans in Beppu also adopt other types of bamboo such as black bamboo (kurochiku), speckled bamboo (gomadake), hachiku and medake, according to their preference. All the bamboo crafts are manually produced from the weaving process to the finish and a wide variety of splendid works have been created with designs refined by traditional techniques over hundreds of years. These bamboo products with traditional beauty –from tableware and other utensils to fine arts and crafts –have been put to regular use.

Several craftsmen have attained higher levels of technique and mastery and Mr. Shono Shounsai in particular has been designated as a Living National Treasure. Since their crafts were designated as “Traditional Works of Art” in 1979 by the Ministry of Trade and Industry, Beppu’s bamboo artisans have been working on various projects, such as nurturing and preserving traditional bamboo craftsmanship and finding further practical uses of their creations.

## Exhibit Room 1

Exhibit Room 1 is divided into several divisions including “History,” “Materials,” “Craftsmanship,” “Daily Life,” and “Future,” all of which express the relationship between man and bamboo in a comprehensive way. At the “Master Craftsman” division, many artworks, which have been produced with master craftsmens’ superior techniques, are displayed, and innovative interior products suitable for the modern life style also can be found here.



## Exhibit Room 2

We hold several exhibitions every year at Exhibit Room 2. Detailed information is available on our website.



Seventy-seventh Artists Exhibition, 2018

## Floor Map

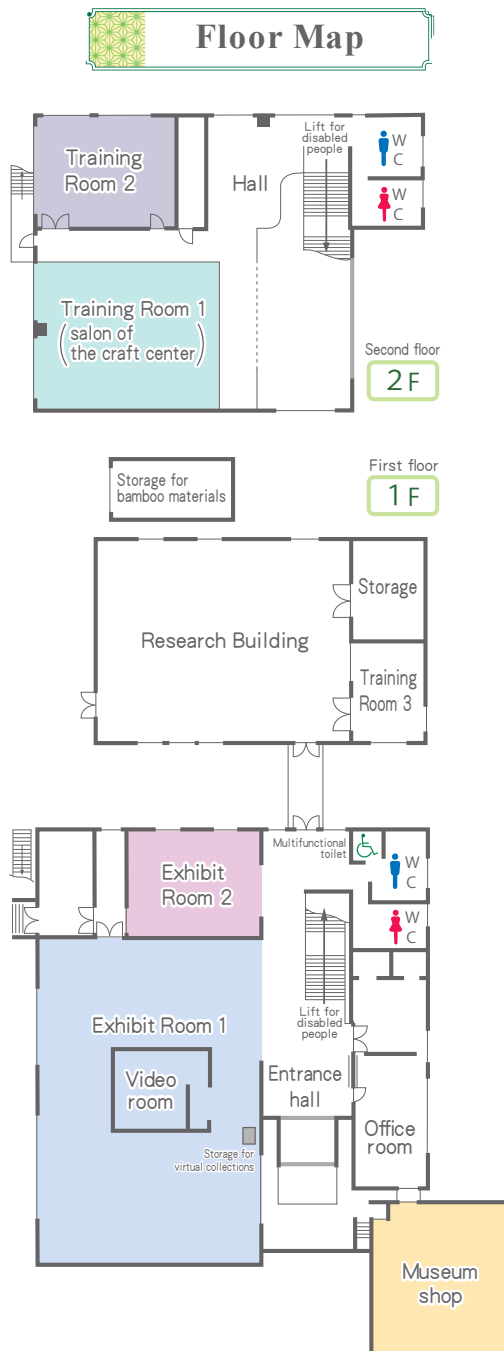

## Training Room

Training Room 1 is used for bamboo classes or as a salon of the craft center where young craftsmen improve their skills and acquire techniques. A number of hands-on experience sessions are also held here for ordinary people and students.

Training Room 2 is also available for each training workshop of design and other craft categories.



## Museum Shop

At this shop, we sell various bamboo products that can add color to your food, clothing and housing. There is also a café where you can relax over a cup of coffee or Japanese green tea, having a beautiful view of bamboo grove.



Cup and Saucer of Onta Pottery

